

## QAP Series

Wall mount multifunctional electric horn which supports 30 built-in sounds and 30 user defined sounds(MP3)



- **QAP100H / QAP125H(MP3)**
  - User defined 30 sounds, 30 built-in sounds
- **QAP100H-N / QAP125H-N (standard unit)**
  - 30 built-in sounds

### PRODUCT SPECIFICATION

QAP80H | QAP100H | QAP125H  
QAP100H-N | QAP125H-N

**Materials** Housing-ABS, Resonance chamber-ABS

**Ambient operating temperature** -25°C to +50°C

**Protection rating** IP65

**Compliant with RoHS directive**

- Signal sound diffusing structure with wall mount supports 30 Built-in sounds and 30 user defined sounds
- Volume control and tone selector switches are installed inside the unit (Buzzer type is unsupported)
- User has the ability to enter voice tones directly into the unit via MP3 files from the SD card
- This product has 30 Built-in sounds via binary input mode or bit input mode
- Binary input mode allows the user to select from 30 different sound options with the tone selection switch
- Bit input mode is organized into 6 groups of 5 sound tones for a total of 30 sound tone options. Playback can be selected from one of the 5 tones in each group (MP3 file with bit input mode)
- Supports both SD card and MP3(QAP100H/QAP125H)
- Standard unit choose built-in sound only. It can choose 30 sounds in accordance with the customer's needs.

### Function setting for multifunctional product

- Standard unit does not support either SD card or Play mode.

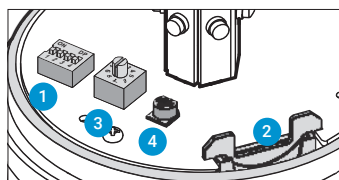

- 1 Sound setup switch
- 2 SD Card for MP3 play
- 3 Play mode set up switch
- 4 Volume

### Sound Selection Instruction for SDcard Type

- SD card type unit
- It can choose both built-in sounds and user defined sounds(MP3) by controlling sound setup switch no. 1.
- Standard unit
- It can choose both Bit input mode and Binary input mode by controlling sound setup switch no. 1.

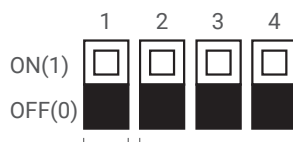

#### Sound Selection

- 0: Built-in sound
- 1: SD Card(MP3)

#### Standard unit(Built-in sound only)

- 0:Bit input(Can choose 5 channels per group)
- 1:Binary(Can choose 30 channels)

#### Bit input mode selection from 6 groups

- 001: WS(5 Warning sounds)
- 010: WP(5 Special warning sounds 1<sup>st</sup> group)
- 011: WM(5 Melodies)
- 100: WA(5 Alarms)
- 101: WO(5 Special warning sounds 2<sup>nd</sup> group)
- 110: WN(5 Special warning sounds 3<sup>rd</sup> group)

- 30 pre-recorded sounds offered(5 warning sounds, 5 special warning sounds 1st group, 5 melodies, 5 alarms, 5 special warning sounds 2nd group, 5 special warning sounds 3rd group)
- External MP3 sound support(SD card)
- Binary input: 30 channels
- Bit input: 5 channels(6 sound groups)
- A multi-functional product that can use an SD card for MP3 playback
- Please refer to [Sound pattern and combination for multifunctional product] on this catalogue for channel input setting.

### Features per modelst

	QAP100H / QAP125H(MP3)	QAP80H / QAP100H-N QAP125H-N(standard unit)	Column
Support SD card(MP3)	O	X	
Support 30 built-in sounds	O	O	
Play mode	O	X	
Bit/Binary input	O	O	Please refer to sound setup switch manual parts

# QAP Series



QAP80H

## QAP80H Electric Horn, Wall Mount Type

Model number	Voltage	Current	Sound pattern and volume	Certificates	Weight
QAP80H	DC12V-24V	Max.850mA	· Bit Input: 5Ch · Binary Input: 30Ch · Built-in volume : Max.100dB (Based on WM-Ch4)	CE	0.51kg

※ DC type model has a free-voltage range of 10V-30V.

## QAP100H Electric Horn, Wall Mount Type

Model number	Voltage	Current	Sound pattern and volume	Certificates	Weight
QAP100H	DC12V-24V	Max.850mA	· Bit Input: 5Ch · Binary Input: 30Ch · Built-in volume : Max.100dB (Based on WA-Ch4)	CE	0.60kg
	AC110-220V	Max.175mA	· MP3: Max.95dB		0.63kg

※ DC type model has a free-voltage range of 10V-30V.

※ AC type model has a free-voltage range of 100V-240V.

※ Please refer to [Sound tone and combination for standard product] on this catalogue for detailed sound tone specification

※ When playing MP3 files, there may be difference of volume depending on user's audio file type.

## QAP125H Electric Horn, Wall Mount Type

Model number	Voltage	Current	Sound pattern and volume	Certificates	Weight
QAP125H	DC12V-24V	Max.1A	· Bit Input: 5Ch · Binary Input: 30Ch · Built-in volume : Max.115dB (Based on WA-Ch4)	CE	0.70kg
	AC110-220V	Max.190mA	· MP3: Max.100dB		0.73kg

※ DC type model has a free-voltage range of 10V-30V.

※ AC type model has a free-voltage range of 100V-240V.

※ Please refer to [Sound tone and combination for standard product] on this catalogue for detailed sound tone specification

※ When playing MP3 files, there may be difference of volume depending on user's audio file type.

## Ordering Specification

QAP80H	-	12/24	-	INSD
[Model number]		[Voltage]		[Including SD card]
QAP80H		12/24-DC12V-24V		
QAP100H		12/24-DC12V-24V		None-Without SD card
QAP125H		110/220-AC110V-220V		INSD-Including SD card



### QAP100H-N Electric Horn, Wall Mount Type

Model number	Voltage	Current	Sound pattern and volume	Certificates	Weight
QAP100H-N	DC12V-24V	Max.850mA	· Bit Input: 5Ch · Binary Input: 30Ch · Built-in volume : Max.100dB (Based on WA-Ch4)	CE	0.60kg
	AC110-220V	Max.175mA			0.63kg

※ DC type model has a free-voltage range of 10V-30V.

※ AC type model has a free-voltage range of 100V-240V.



QAP100H / QAP100H-N

### QAP125H-N Electric Horn, Wall Mount Type

Model number	Voltage	Current	Sound pattern and volume	Certificates	Weight
QAP125H-N	DC12V-24V	Max.1A	· Bit Input: 5Ch · Binary Input: 30Ch · Built-in volume : Max.115dB (Based on WA-Ch4)	CE	0.70kg
	AC110-220V	Max.190mA			0.73kg

※ DC type model has a free-voltage range of 10V-30V.

※ AC type model has a free-voltage range of 100V-240V.

### Ordering Specification

QAP100H-N	-	12/24
[Model number]   QAP100H-N QAP125H-N		[Voltage]   12/24-DC12V-24V 110/220-AC110V-220V

# QAP Series

## Technical Diagram

Units: mm

### ·QAP80H

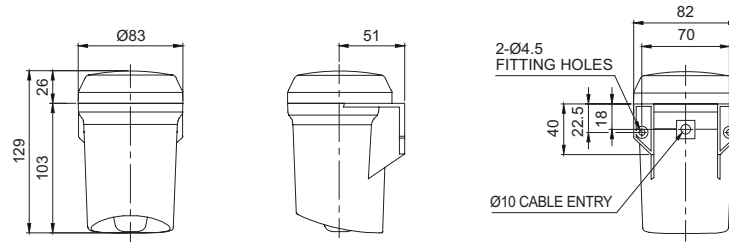

### ·QAP100H / QAP100H-N

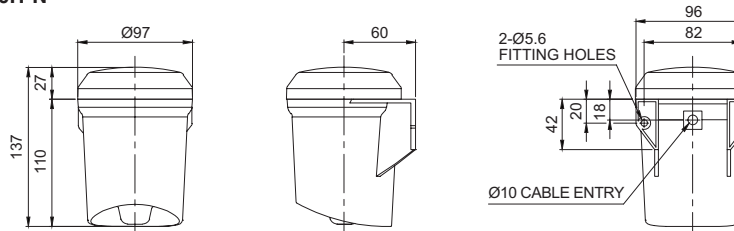

### ·QAP125H / QAP125H-N

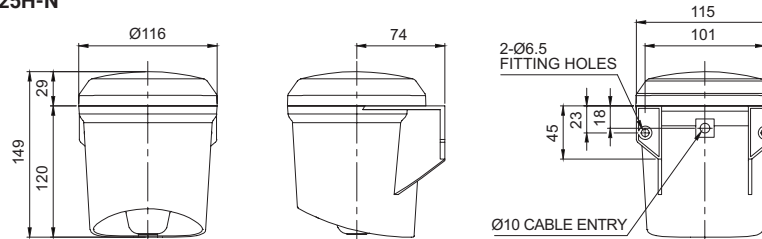

## Wiring Instructions

### ·QAP80H-DC / QAP100H-DC/AC ·QAP100H-N-DC/AC

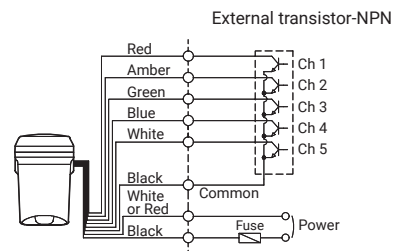
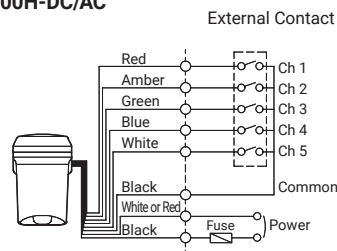

### ·QAP125H-DC/AC ·QAP125H-N-DC/AC

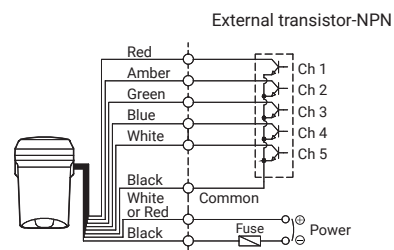
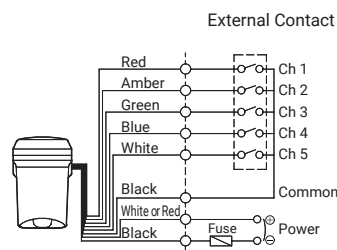

- External Power line - UL1015 AWG18(0.75sq) x 2C 400mm
- External signal line - UL1007 AWG22(0.3sq) 400mm
- QAP80H / QAP100H - This product can be wired regardless of polarity.
- QAP125H - Black output line is negative(-).
- In case of Bit input, 5 sound tones can be played. For Binary input, 30 sound tones can be played.
- ※ Please refer to [Sound pattern and combination for multifunctional product] on this catalogue for channel input setting(Wiring instruction is replaced to channel selection switch)