

PRODUCT SPECIFICATION

ETA50L

Materials Housing-Al, Lens-PC**Ambient operating temperature** -25°C to +55°C**Volume** Max. 85dB at 1m**Protection rating** IP20

- Pole-mounted Performance Line adopting high-brightness LED as a light source
- High visibility from a distance by using a transparent globe
- Excellent durability by using aluminum housing
- Equipped with a foldable bracket to respond to various external environments
- Buzzer type can be selected for lighting or blinking specifications



ETA50L

ETA50L Industrial LED beacon

Model number	Layers	Voltage	Current	Certificates	Weight	Color
ETA50L Steady						
ETA50L-BZ Steady w/built-in buzzer	3	DC24V	85mA	CE eRU	0.55kg	● R-Red ● A-Amber ● G-Green
ETA50LF Flashing						
ETA50LF-BZ Flashing w/built-in buzzer						

※ RU compliant: ETA50LF, ETA50LF-BZ

Wiring Instructions

- ETA50L series can be wired by using both external contact and transistor.
- Wiring to transistor, use the PNP transistor. Please wire properly based on wiring instructions.

- ETA50L / ETA50L -BZ
- ETA50LF / ETA50LF -BZ

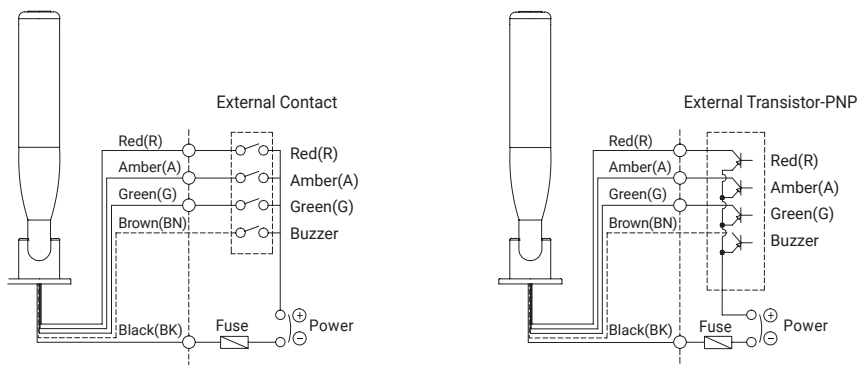

※ ETA50L / ETA50L-BZ: Steady, ETA50LF / ETA50LF-BZ: Flashing

Ordering Specification

ETA50L	-	3	-	24	-	RAG
[Model number]		[Layers]		[Voltage]		[Color]
ETA50L ETA50L-BZ ETA50LF ETA50LF-BZ		3-3 Layers		24-DC24V		● R-Red ● A-Amber ● G-Green

Technical Diagram

Units: mm

- ETA50L / ETA50L -BZ
- ETA50LF / ETA50LF -BZ

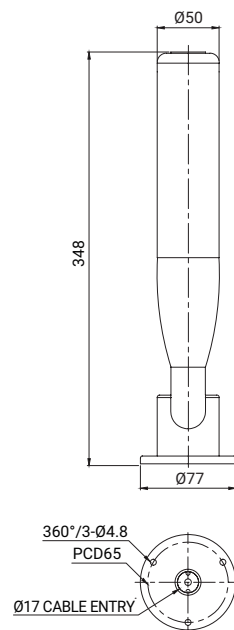

Customization

- NPN type