



SMP35 / SMP50

- **SMP35/SMP50(MP3)**
 - User defined 30 sounds, 30 built-in sounds
- **SMP35-N/SMP50-N(standard unit)**
 - 30 built-in sounds

PRODUCT SPECIFICATION

SMP35 | SMP35-N
SMP50 | SMP50-N

Materials Housing-ABS, Resonance chamber-ABS, Bracket-STS

Ambient operating temperature -25°C to +50°C

Protection rating IP65

Compliant with RoHS directive

- Can prevent cross talk of different voice environments by selecting an audio signal fit for the specific environment and condition
- 30 pre-recorded sound type and supports Binary input mode and Bit input mode
- Binary input mode can playback 30 sound tones by using sound tone select switch
- Bit Input Mode classifies 30 pre-recorded sounds into 6 groups of 5 sounds, and selects one group to play 5 sounds (In case of using MP3 files, group selection function is not supported).
- SMP35 model uses 30W and SMP50 model uses high-volume 50W unit. You can select and use proper model depending on installation environment
- Volume adjustment and sound selection switches located inside the unit. SD card in the unit offers convenient operation
- Support MP3 file and user can input user defined sound
- Standard unit choose built-in sound only. It can choose 30 sounds in accordance with the customer's needs.

Channel Input Type of Multifunctional Product

- Standard unit does not support either SD card or Play mode.

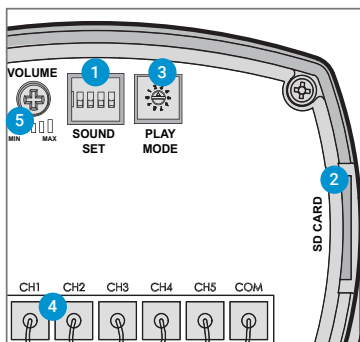

- 1 Switch for sound pattern selection
- 2 SD card slot for MP3
- 3 Switch for play mode selection
- 4 Switch for channel selection
- 5 Switch for volume adjustment

Sound Selection Instruction for SDCard Type

- SD card type unit
- It can choose both built-in sounds and user defined sounds(MP3) by controlling sound setup switch no. 1.
- Standard unit
- It can choose both Bit input mode and Binary input mode by controlling sound setup switch no. 1.

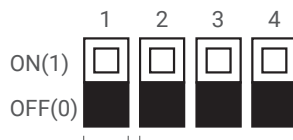

Sound Selection
0: Built-in sound
1: SD Card(MP3)

Standard unit(Built-in sound only)

- 0: Bit input(Can choose 5 channels per group)
- 1: Binary(Can choose 30 channels)

Bit input mode selection from 6 groups

- 001: WS(5 Warning sounds)
- 010: WP(5 Special warning sounds 1st group)
- 011: WM(5 Melodies)
- 100: WA(5 Alarms)
- 101: WO(5 Special warning sounds 2nd group)
- 110: WN(5 Special warning sounds 3rd group)

- 30 pre-recorded sounds offered(5 warning sounds, 5 special warning sounds 1st group, 5 melodies, 5 alarms, 5 special warning sounds 2nd group, 5 special warning sounds 3rd group)
- External MP3 sound support(SD card)
- Binary input: 30 channels
- Bit input: 5 channels(6 sound groups)
- A multi-functional product that can use an SD card for MP3 playback
- Please refer to [Sound pattern and combination for multifunctional product] on this catalogue for channel input setting.

Features per modelst

	SMP35/SMP50 (MP3)	SMP35-N/SMP50-N (standard unit)	Column
Support SD card(MP3)	O	X	
Support 30 built-in sounds	O	O	
Play mode	O	X	
Bit/Binary input	O	O	Please refer to sound setup switch manual parts

Self Stand Type Electric Signal Horn

SMP Series

SMP35 / SMP50 Multifunctional Self Stand Type Electric Signal Horn(Supports Warning Sound/MP3)

Model number	Voltage	Current	Sound pattern and volume	Certificates	Weight
SMP35	DC12V-24V	Max.760mA	·Bit Input: 5Ch ·Binary Input: 30Ch ·Built-in sounds: Max.115dB (Based on WS-Ch4)	CE	0.76kg
	AC110V-220V	Max.200mA	·MP3: Max.113dB		1.03kg
SMP50	DC12V-24V	Max.2.85A	·Bit Input: 5Ch ·Binary Input: 30Ch ·Built-in sounds: Max.123dB (Based on Ch6)		0.95kg
	AC110V-220V	Max.720mA	·MP3: Max.120dB		1.23kg

· Powerful 50W unit can generate high signal sound(SMP50)

※ DC type model has a free-voltage range of 10V-30V.

※ AC type model has a free-voltage range of 100V-240V.

※ When playing MP3 files, there may be difference of volume depending on user's audio file type.

SMP35-N / SMP50-N Self Stand Type Electric Signal Horn(Supports Warning Sound)

Model number	Voltage	Current	Sound pattern and volume	Certificates	Weight
SMP35-N	DC12V-24V	Max.680mA	·Bit Input: 5Ch ·Binary Input: 30Ch ·Built-in sounds: Max.115dB (Based on WS-Ch4)	CE	0.76kg
	AC110V-220V	Max.170mA			1.03kg
SMP50-N	DC12V-24V	Max.2.85A	·Bit Input: 5Ch ·Binary Input: 30Ch ·Built-in sounds: Max.123dB (Based on Ch6)		0.95kg
	AC110V-220V	Max.720mA			1.23kg

· Powerful 50W unit can generate high signal sound(SMP50-N)

※ DC type model has a free-voltage range of 10V-30V.

※ AC type model has a free-voltage range of 100V-240V.

Technical Diagram

Units: mm

·SMP35 / SMP50

·SMP35-N / SMP50-N

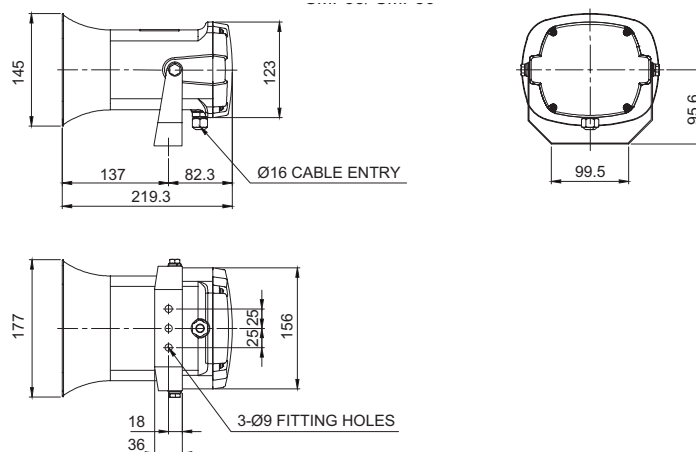



Sound Selection and Wiring Instructions

- Customized type: Select using the External Contact(LC)
- You can select the audible sound pattern using External Contacts or transistor with a customized external sound line(Model number: -LC)

·SMP35 / SMP50-DC/AC

·SMP35-N / SMP50-N-DC/AC

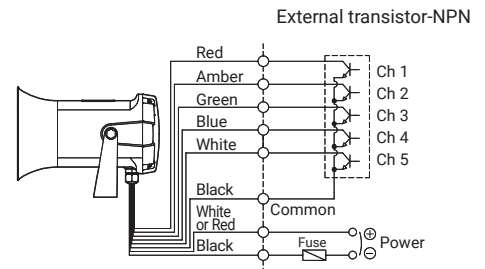
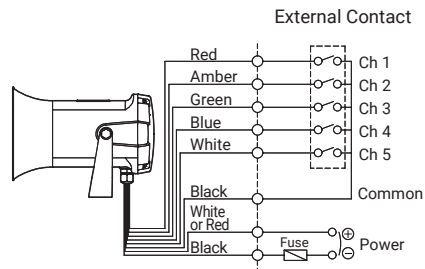

- DC type : Black output is negative(-)
- In case of Bit input, 5 sound tones can be played. For Binary input, 30 sound tones can be played.
- ※ Please refer to [Sound pattern and combination for multifunctional product] on this catalogue for channel input setting(Wiring instruction is replaced to channel selection switch)

Ordering Specification

·SMP35 / SMP50

SMP50	-	12/24	-	LC	-	INSD
[Model number]		[Voltage]		[Sound selection]		[Including SD card]
SMP35		12/24-DC12V-24V		(None) - Internal switch		None-Without SD card
SMP50		110/220-AC110V-220V		LC Type-Uses external contact		INSD-Including SD card

·SMP35-N / SMP50-N

SMP50-N	-	12/24	-	LC
[Model number]		[Voltage]		[Sound selection]
SMP35-N		12/24-DC12V-24V		(None) - Internal switch
SMP50-N		110/220-AC110V-220V		LC Type-Uses external contact