

# EMCL Series



EMCL30

EMCL50

## PRODUCT SPECIFICATION

EMCL30 | EMCL50  
EMCL70 | EMCL90

**Materials** Housing-Al, Lens-PC

**Ambient operating temperature** -25°C to +55°C

**Volume** Max. 85dB at 1m

**Protection rating**

Standard type-IP69K, Built-in buzzer type-IP20

- Small indicator light capable of transmitting three signal colors with one indicator light
- By applying a milky translucent lens, the unique color of the LED is emitted subtly when turned on
- Respond to customer needs with various outer diameters (30mm, 50mm, 70mm, 90mm) and designs
- Waterproof and dustproof model with fully sealed structure with IP69K degree of protection to cope with harsh environmental conditions
- Buzzer specifications can be selected for signal wire withdrawal type or M12 connector mounting type



## EMCL Series Industrial LED beacon

Model number	Voltage	Current	Certificates	Weight	Color		
EMCL30 Steady	DC24V	40mA		0.05kg	<div><div></div> R-Red</div> <div><div></div> A-Amber</div> <div><div></div> G-Green</div>		
EMCL30-BZ Steady w/built-in buzzer							
EMCL50 Steady				0.09kg			
EMCL50-BZ Steady w/built-in buzzer							
EMCL70 Steady		61mA		0.16kg			
EMCL70-BZ Steady w/built-in buzzer							
EMCL90 Steady				0.21kg			
EMCL50-EMCL90-BZ Steady w/built-in buzzer							

### Bracket

- It can be installed on the wall by adopting wall mounting type bracket.



Φ23.5 type



Φ32 type



Mount bracket

### Wiring Instructions

#### • EMCL Series

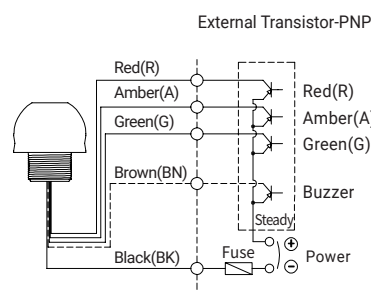
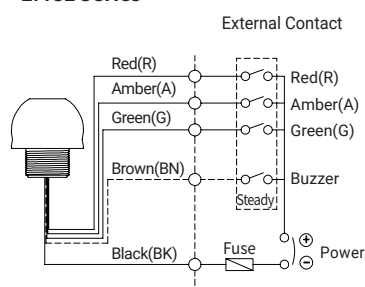

## Technical Diagram

Units: mm

### • EMCL30 / EMCL30-BZ

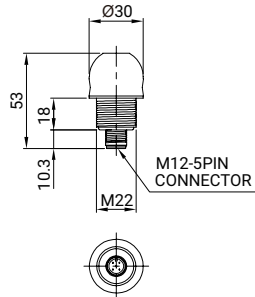

### • EMCL50 / EMCL50-BZ

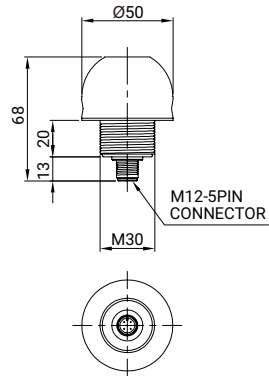

### • EMCL70 / EMCL70-BZ

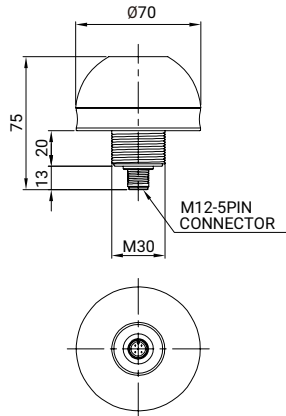

### • EMCL90 / EMCL90-BZ

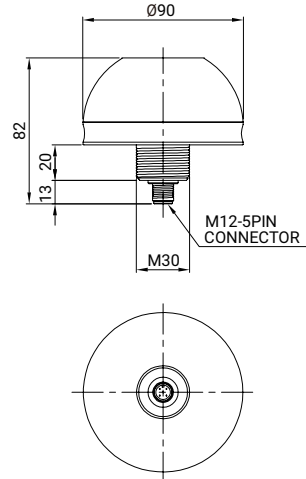

EMCL70

EMCL90

## Customization

- M12 Five- Core Cable/1.5m
- NPN type

## M12 connector type

5PIN CONNECTOR	No.	Color	Wiring
	1	RED	Pin 1
	2	AMBER	Pin 2
	3	GREEN	Pin 3
	4	Common	Pin 4
	5	Buzzer	Pin 5

## Ordering Specification

EMCL30	-	24	-	RAG	-	M12
[Model number]		[Voltage]		[Color]		[Cable]
EMCL30		24-DC24V		● R-Red		None-External contact
EMCL30-BZ				● A-Amber		M12-M12 connector type
EMCL50				● G-Green		
EMCL50-BZ						
EMCL70						
EMCL70-BZ						
EMCL90						
EMCL90-BZ						