

## SJ Series



SJ



SJLP

### PRODUCT SPECIFICATION

SJ | SJL

**Materials** Lens-AS, Body-ABS, Reflector-Heat resistant ABS

**Volume** Max 90dB at 1m

**Protection rating** IP44

**Standard color** 1st layered - ● Red  
2nd layered - ● Red ● Green  
3rd layered - ● Red ● Yellow ● Green

- Beautiful appearance from stacking 95×95mm cubed tower lights
- Multi signal transmission in space of 1 signal light

### SJ / SJLP Stackable Signal Lights/Warning Lights

Model number	Layer	Voltage	Bulb			Certificates	Weight	Color
			Spec	Standard	Parts no			
SJ SJLP	1	DC12V	12V5W	T16x35 15S	5	CE	0.65kg	● R-Red
		DC24V	24V5W	T16x35 15S	6		0.65kg	
		AC110V	12V5W	T16x35 15S	5		0.83kg	
		AC220V	12V5W	T16x35 15S	5		0.83kg	
	2	DC12V	12V5W	T16x35 15S	5		0.89kg	● R-Red ● G-Green
		DC24V	24V5W	T16x35 15S	6		0.89kg	
		AC110V	12V5W	T16x35 15S	5		1.15kg	
		AC220V	12V5W	T16x35 15S	5		1.15kg	
	3	DC12V	12V5W	T16x35 15S	5		1.18kg	● R-Red ● A-Amber ● G-Green
		DC24V	24V5W	T16x35 15S	6		1.18kg	
		AC110V	12V5W	T16x35 15S	5		1.28kg	
		AC220V	12V5W	T16x35 15S	5		1.28kg	

- Adopts a special Power transmission system which minimizes noise and wear
  - Available in customized color arrangements
  - Revolving speed: 120-140RPM
  - Ambient operation temperature: -20°C to +50°C
- ※ CE compliant: DC12V, DC24V

### Light source current(based on 1 layer)

Voltage	DC12V	DC24V	AC110V	AC220V
Light source current(1 layer)	490mA	350mA	100mA	50mA
Buzzer current	15mA	35mA	60mA	30mA

### Technical Diagram

Units: mm

·SJ / SJL

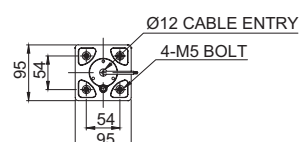
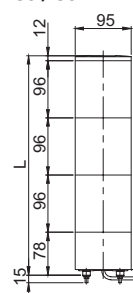

·SJLP / SJLPL

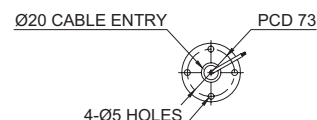
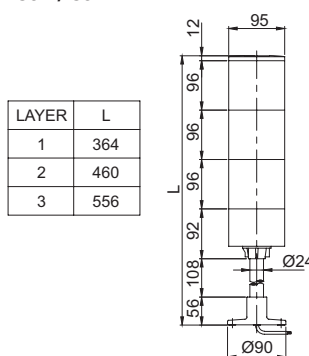

### Cautions in use

- SJL/ SJLP type can be wired with external contacts and transistor.
- Wiring to transistor, use the NPN transistor. Please wire properly based on technical diagram.
- SJ/ SJLP used bulb can not be connected by using transistors. Please use the External Contacts.



## SJL / SJLP Stackable Warning/ Signal Lights

Model number	Layer	Voltage	Certificates	Weight	Color
SJL SJLP	1	DC12V-24V	-	0.63kg	● R-Red
		AC110V		0.80kg	
		AC220V		0.80kg	
	2	DC12V-24V		0.76kg	● R-Red
		AC110V		1.03kg	● G-Green
		AC220V		1.03kg	
	3	DC12V-24V		1.01kg	● R-Red
		AC110V		1.24kg	● A-Amber
		AC220V		1.24kg	● G-Green

- Strong LED signal light emitted through the 96mm height diffusion lens
- Fixed lens colors
- Flashing rate: 60-80 flashes/min
- Ambient operation temperature: -30°C to +50°C
- Compliant with RoHS directive



SJL

### Light source current(based on 1 layer)

Voltage	DC12V-24V	AC110V	AC220V
Light source current(1 layer)	Max.185mA	80mA	40mA
Buzzer current	Max.35mA	60mA	30mA

### Wiring Instructions

#### ·SJ(P) / SJL(P)-DC

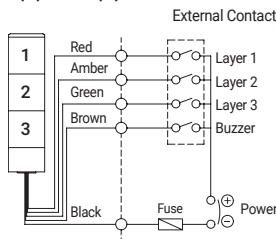

#### ·SJ(P) / SJL(P)-AC

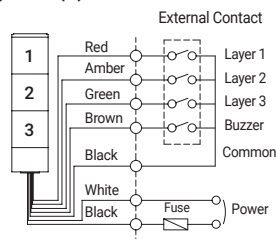

#### ·SJL(P)-DC

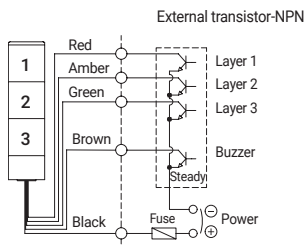

#### External transistor-PNP

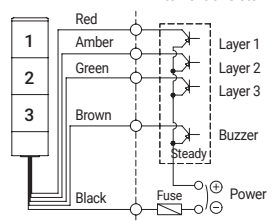

SJLP

- External Power line - UL1015 AWG18(0.75sq) x 2C 400mm
- External signal line - UL1007 AWG22(0.3sq) 400mm
- SJ, SJP type: Black output line is negative(-).

### Ordering Specification

SJL	-	BZ	-	3	-	220	-	RAG
[Model number]		[Buzzer option]		[Layer]		[Voltage]		[Color]
SJ		(None)		1-1Layer		12-DC12V		● R-Red
SJP		- No buzzer		2-2Layers		24-DC24V		● A-Amber
SJL		BZ		3-3Layers		12/24-DC12V-24V		● G-Green
SJLP		- Built-in buzzer				(SRL, SRLP Only)		
						110-AC110V		
						220-AC220V		

### Customization

- 4 layers available upon request
- Lens colors arrangement except for standard
- 2 buzzer sound types: Both prolonged(beep, beep) and staccato(beep, beep, beep) buzzer output available
- Xenon lamp strobe type (model number: SJS / SJSP)