



Revolving warning lights with detachable rubber magnet for emergency response vehicles



SKMP / SKMPH



SKMPLR

PRODUCT SPECIFICATION

SKMP | SKMPH

Materials Lens-PC, Housing-PC, Reflector-PC/STS

Ambient operating temperature -20°C to +50°C

Protection rating IP54

Revolving speed 120-140RPM

- Exceptional attachment to vehicles which operate in shock and vibration environments
The rubber magnet securely attaches along the curved surfaces of the vehicle
- Detachable rubber magnet equipped to prevent potential scratches in vehicle's surface
- Contains a spare bulb inside the product
- Easy Power connection with cigarette lighter plug equipped
- DC(12V, 24V) only

SKMP / SKMPH Streamlined Bulb Revolving Warning Lights

Model number	Voltage	Current	Bulb			Certificates	Weight	Color
			Spec	Standard	Parts no			
SKMP	DC12V	1.55A	12V15W	G23 15S	17		0.78kg	● R-Red
	DC24V	765mA	24V15W	G23 15S	18		0.78kg	● A-Amber
SKMPH	DC12V	3.5A	12V35W	15S halogen	39		0.78kg	● G-Green
	DC24V	1.85A	24V35W	15S halogen	40		0.78kg	● B-Blue

SKMPLR Streamlined LED Revolving Warning Light

Model number	Voltage	Current	Certificates	Weight	Color
SKMPLR	DC12V	420mA	-	0.63kg	● R-Red
	DC24V	265mA		0.63kg	● A-Amber ● G-Green ● B-Blue



Special rubber magnet adheres securely to the vehicle's surface without damaging it!

SKMP, SKMPH, SKMPLR has a largesized rubber magnet to prevent potential damage on the vehicle's surface. The special rubber magnet adheres securely to the vehicle and it does not be detached from sudden deceleration and road impacts.

Technical Diagram

Units: mm

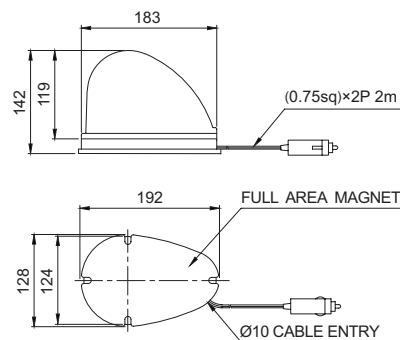

Wiring Instructions

- Cigarette lighter plug, IEC42(0.75sq) x 2P 2m

Customization

- Oval-shaped rubber magnet

Ordering Specification

SKMP	-	24	-	R
[Model number]		[Voltage]		[Color]
SKMP SKMPH SKMPLR		12-DC12V 24-DC24V		● R-Red ● A-Amber ● G-Green ● B-Blue