

Warning Light Bars for Emergency Vehicle Set

QLV-SET

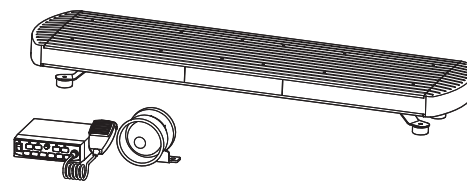

Thank you for purchasing Qlight's products. Please read this user manual carefully prior to installation and operation to ensure safe and correct use.

⚠ Precautions for Safety

Failure to follow the instructions below may cause a loss of life or serious physical injury.

1. During wiring or maintenance, please completely turn off the power of the product. (Failure to follow this may lead to an electric shock.)
2. Do not install the product in locations that subjects it to excessive dust or water other than the conditions designated by the IP protection ratings indicated for each product. (Failure to follow these instructions may cause a fire to the product, electric shock, physical injury, malfunction or damage to the product.)
3. Do not alter or repair this product. If maintenance or repair service is required, please contact your local Qlight contact point. (Failure to follow these instructions may lead to fire, electric shock, or product damage.)
4. Please apply the correct voltage to the product. (Failure to follow these instructions may lead to fire, electric shock, or product damage.)
5. When the product is applied to a condition that may impact lives or property, please make sure to have a double safety device. (Failure to follow this may cause damage to property, fire, electric shock and loss of life.)

⚠ Precautions for Correct Use

Failure to follow the proper instructions may cause damage to property, the product, or malfunction of the product that would void the warranty.

1. Please remove any objects that can interrupt ventilation around the product.
2. Please turn off the power of the product immediately if it fails to operate properly.
3. Carefully wire the product according to each product's specification.
4. Please be careful in preventing chemicals such as thinner, benzene, etc. in contact with the surface of the product.
5. Do not apply excessive force/impact to the product.
6. Failure to follow any of the instructions above may cause malfunction or damage to the product, fire, and electric shock.

Ordering Specifications

QLV-1150	-	12	-	B/R	-	SAMP	-	HORN
[Model number]		[Voltage]		[Color]		[Amplifier]		[Horn]
<ul style="list-style-type: none"> • QLV-1250 • QLV-1150 • QLV-885 		<ul style="list-style-type: none"> • 12-DC12V 		<ul style="list-style-type: none"> B/R - Blue-Red R/R - Red-Red A/A - Amber-Amber G/G - Green-Green 		<ul style="list-style-type: none"> • SAMP - SAMP-100 included 		<ul style="list-style-type: none"> • HORN - SM-100ND included

Product Specifications

Model number	LED Module number	Voltage	Current	Volume	Certificate	Weight	Color
QLV-1250-SET	24EA	DC12V	26.5A	Max. 135dB	CE	20.31kg	B(Blue-Red)
QLV-1150-SET	22EA		26A			19.42kg	R(Red-Red)
QLV-885-SET	18EA		25A			16.77kg	A(Amber-Amber)
							G(Green-Green)



Please scan the QR code for more detailed product information.

www.qlight.com

- Protection rating : IP56(QLV only)
- Ambient operating temperature : -30°C to +50°C

QLV-1250

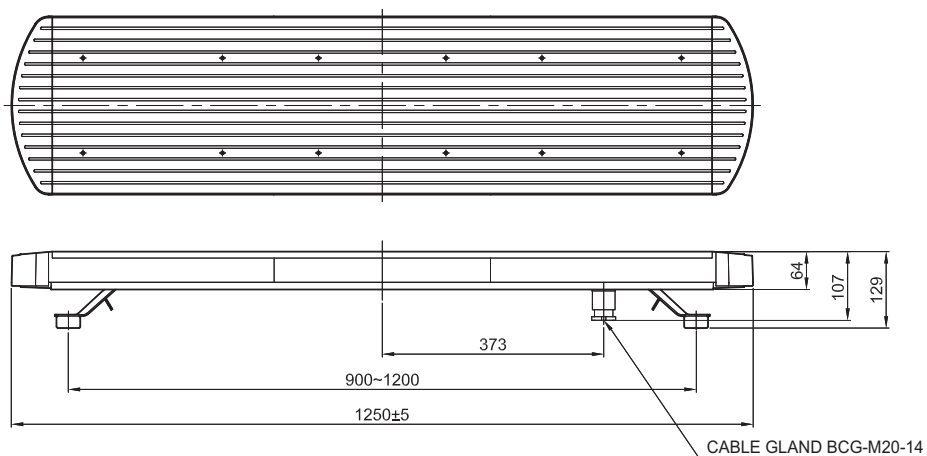

QLV-1150

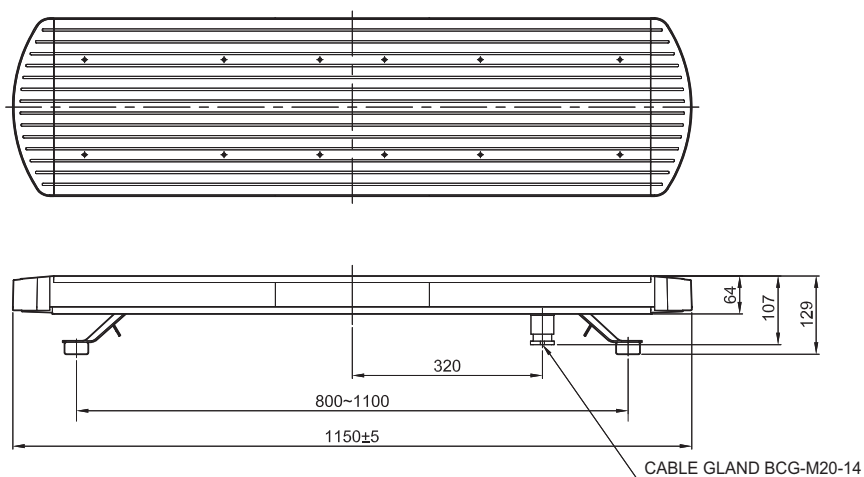

QLV-885

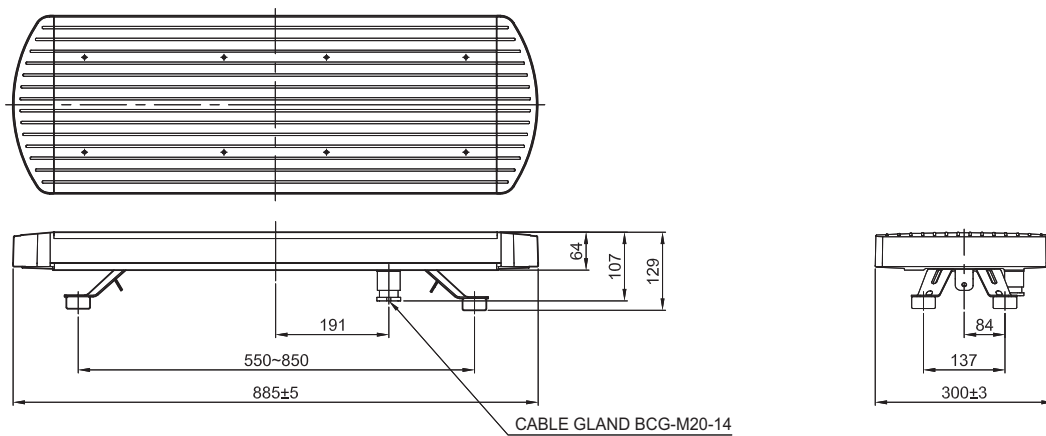

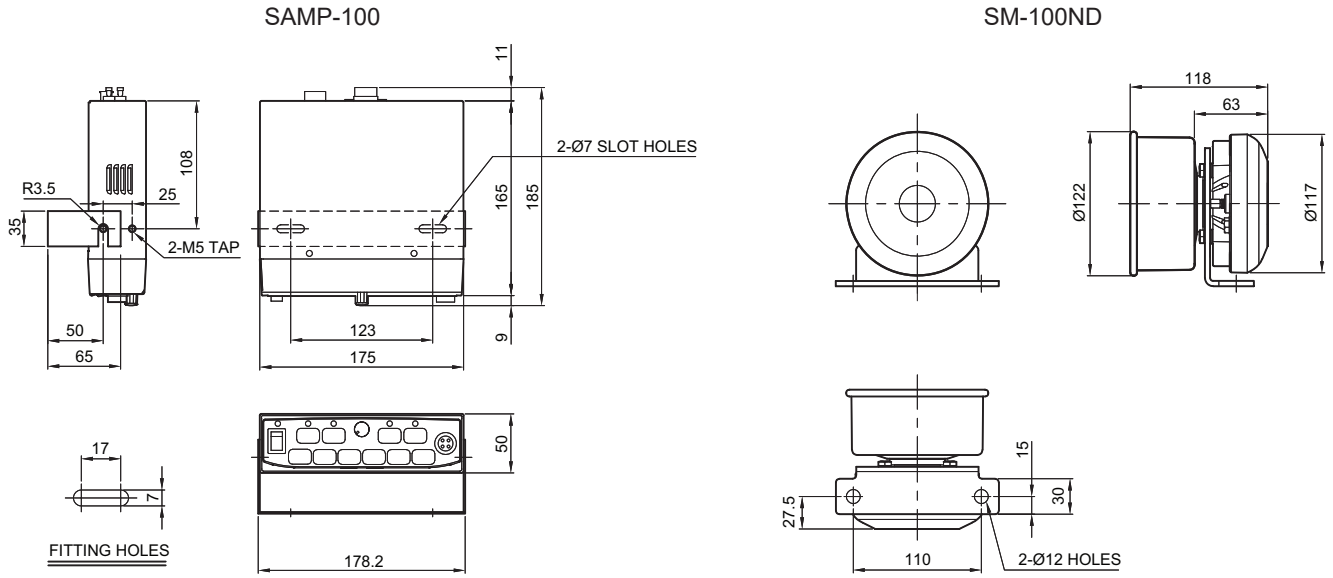

Wiring Instructions

- SAMP-100 control unit has a 7p connector and SAMP-100 power unit has a 5p connector, and the QLV warning light bar has 10 connector.
- Refer to the connector pin map below for wiring instructions.
- For the power unit, please make sure to use a fuse to ensure the product operates properly.

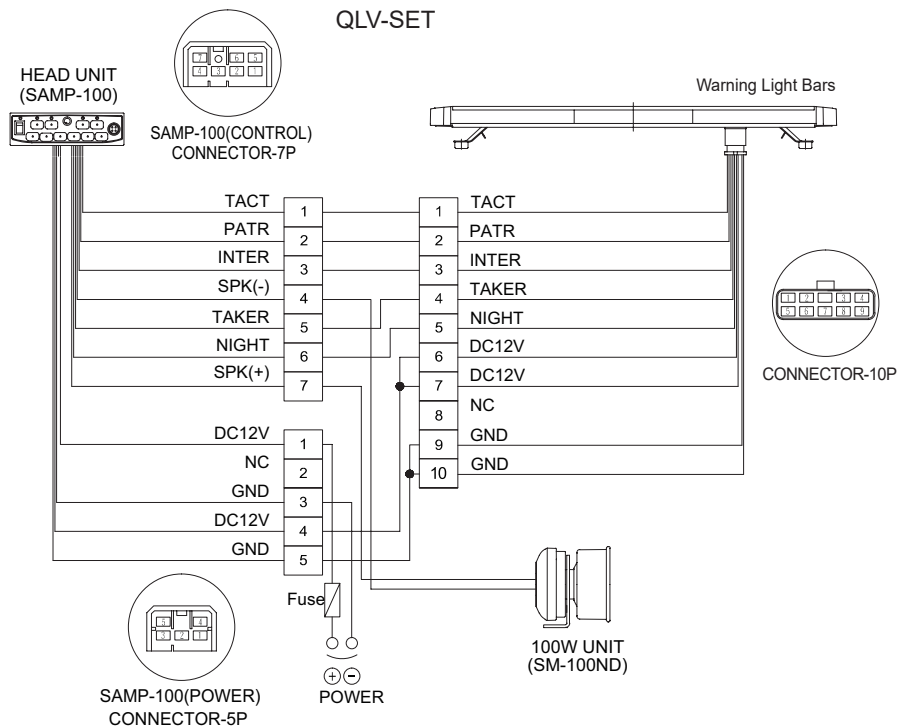

Parts Definition/ Installation

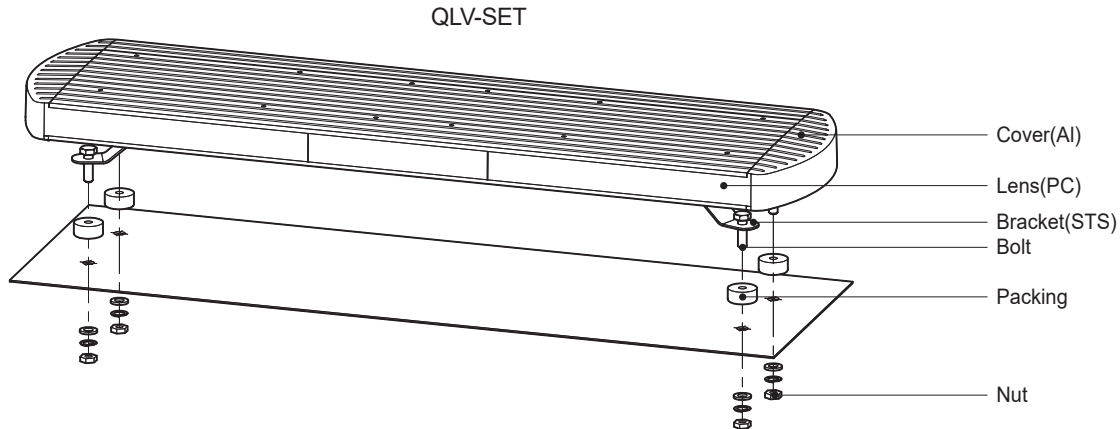

- First, machine taps or holes on the mounting surface.
- The mounting hole of this product is 9mm(QLV), 7mm(SAMP-100) and 12mm(SM-100ND) in diameter(long hole).
- Insert the bolt through the hole of the product, and tighten the nut from the opposite side of the mounting surface.
- Please fasten the nuts until the bolts are tightened securely.
- Use a flat washer and spring washer in the bolt assembly if the product will experience severe vibration and shock.

Bracket Adjustment

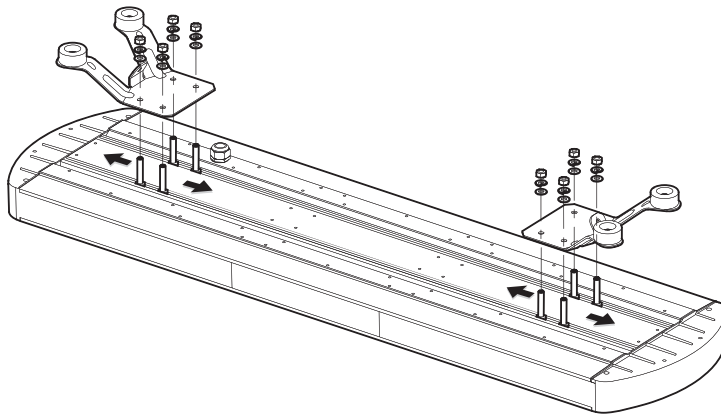

- To adjust the bracket location, please first remove the nuts(M8) that fasten the product and move the brackets to the desired location.
- After properly aligning the brackets to the desired pitch circular diameter (PCD) locations on the mounting surface, fasten the nuts until they tighten securely.

Mounting Hole Specifications

- Machine holes on the mounting surface referring to the diagram below.

MODEL	A
QLV-1250	900-1200
QLV-1150	800-1100
QLV-885	550-850

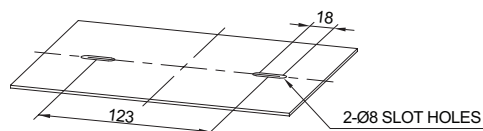
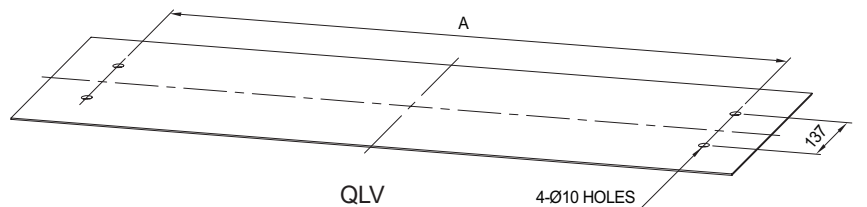

SAMP-100

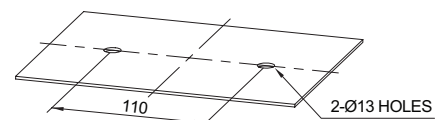

SM-100ND

Installation Environment and Protection Rating

- This product is designed for use with protection rating of IP56.
- If the product is installed in locations that subject it to excessive dust or water other than the designated IP protection rating indicated(IP56), it may cause malfunction or damage to the product.
- In case of outdoor applications, installation in the upright position or horizontal position are required and do not install the product upside-down where rain or moisture flow in.
- For further information, please visit our website (<http://www.qlight.com>)

Product Functions

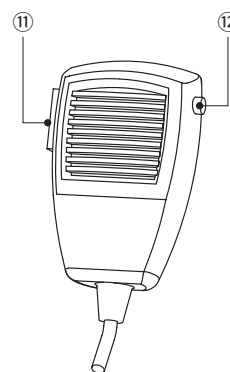
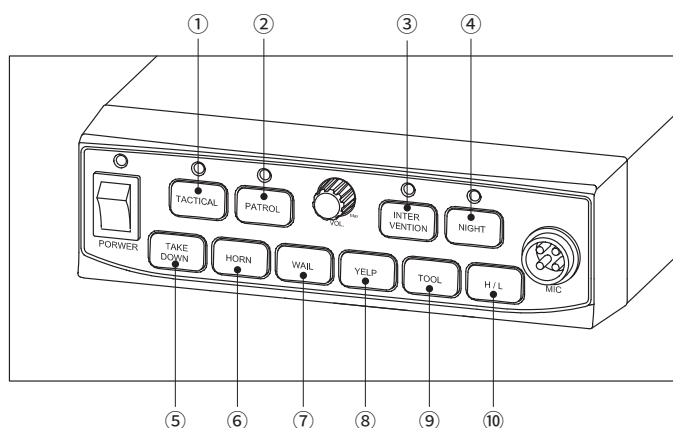

Number	Functions	Action
1	TACTICAL	Strobe function for the entire warning light bar
2	PATROL	Strobe function starting from the middle and radiating outwards continuously
3	INTERVENTION	Strobe function radiating from left to right continuously
4	NIGHT	Light intensity reduced to 25-30% of normal operation
5	TAKE DOWN	All LED modules on
6	HORN	Horn sound on
7	WAIL	Wail emergency sound on (A-ANG)
8	YELP	Yelp emergency sound on (WA-U)
9	TOOL	Piercer emergency sound on (DI-DI-DI-DI)
10	H / L	High-low emergency sound on (PI-PO)
11	HOOK KEY	Button for voice announcement when pressed down.
12	TACT SWITCH	Strobe function 1(tactical) and yelp emergency sound on

Product installation direction

- Install the product in accordance with the manual. Otherwise rainwater or moisture may penetrate into the product.

· BEACON/SIGNALING LIGHT

※ For products with a protection rating of less than IPX4, please install it vertically.

Power cord inlet part shall not be facing the sky.

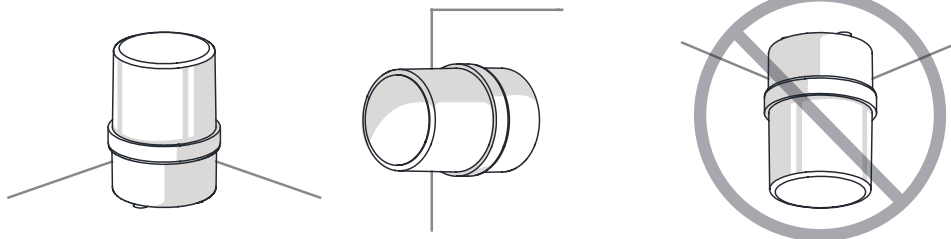

· ELECTRONIC SOUNDER/SIGNAL HORN

Sounder part shall not be facing the sky.

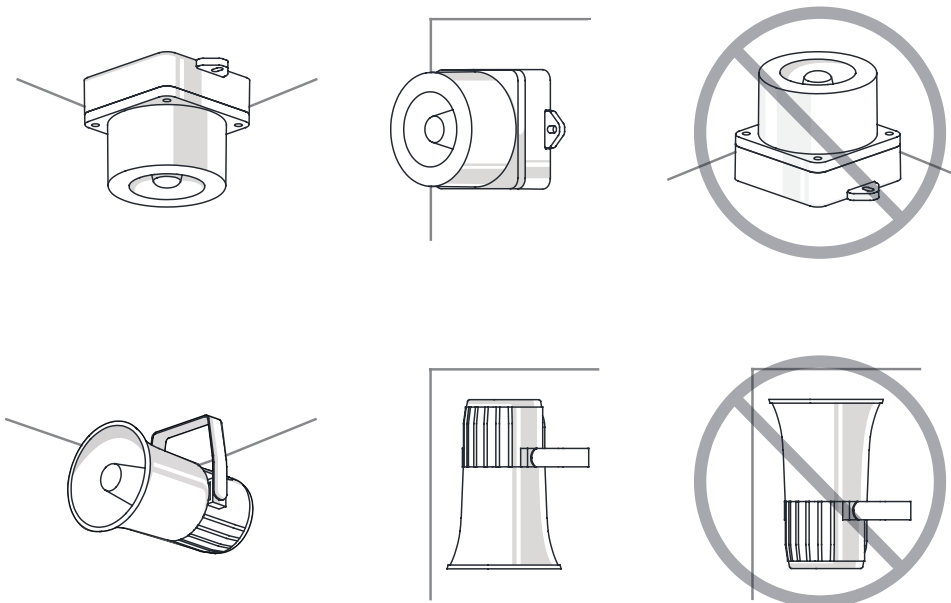

· HEAVY-DUTY & EXPLOSION PROOF SIGNALINGS

Sounder part shall not be facing the sky.

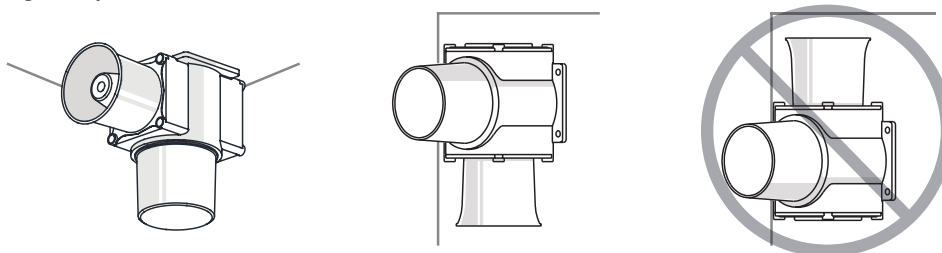

· SIGNAL TOWER LIGHTS

※ For products with a protection rating of less than IPX4, please install it vertically.

Power cord inlet part shall not be facing the sky.

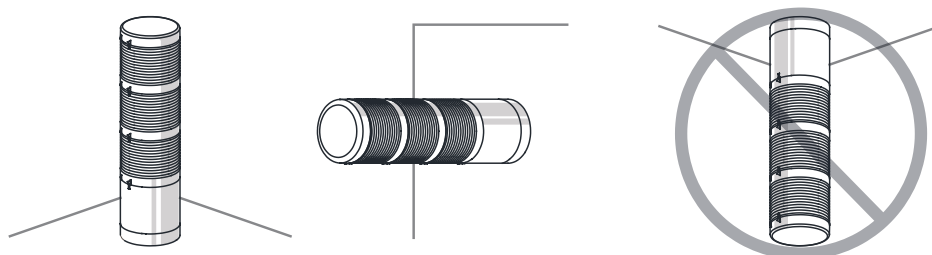

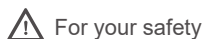

For your safety

Specification and dimensions listed in this catalogue subject to change without notice for product quality improvement.
The newest product information is available on our website.(www.qlight.com)
Please read the instruction manual attached to the product carefully before installation and use.

Qlight Co., Ltd. www.qlight.com | trade@qlight.com

Head Office | Suite #1510, STX-V Tower, 128 Gasan digital 1-ro, Geumcheon-gu, Seoul, Korea

Tel. +82-2-2679-6152(Toll free. +82-80-328-2222) Fax. +82-2-2679-6154

Factory | 185-25, Mukbang-ro, Sangdong-myeon, Gimhae-si, Gyeongsangnamdo, Korea Tel. +82-55-328-1111(Toll free. +82-80-328-1111)

Qlight Overseas Sales Dept | 704 Nakdong-daero, Sasang-gu, Busan, Korea(Eomgung-Dong) Tel : +82-51-620-4100

Qlight Public Relations & Marketing Team Office | 704 Nakdong-daero, Sasang-gu, Busan, Korea(Eomgung-Dong) Tel. +82-51-245-0017

SHANGHAI Qlight Electronic Co., Ltd. www.qlight.com www.qlightcn.com | qlightcn@qlight.com

China Factory/ Shanghai Sales Office | #Room 333 Building B, #11, Lane 450, Zhenda Road, Baoshan District, Shanghai, China

Tel. +86-21-6651-7100 Fax. +86-21-6315-3929

China Factory Site 2 (Qidong) | #33, Haiyan Road, Qidong High-tech Industrial Development Zone, Qidong, Jiangsu Province, China

Tel +86-513-8384-9999 Fax +86-513-8384-9910

Qlightec

Innovation in Alarm & Signal

Product Operation Inquiry / Customer Support +82-51-620-4100

You can expect prompt service if you have exact information such as model name, symptom, telephone number and address.

※ALL PRODUCT, PRODUCT SPECIFICATIONS AND DATA ARE SUBJECT TO CHANGE WITHOUT NOTICE TO IMPROVE RELIABILITY, FUNCTION OR DESIGN OR OTHERWISE.

Head office : Suite #1510, STX-V Tower, 128 Gasan digital 1-ro, Geumcheon-gu, Seoul, Korea (Postal Code : 08507)

Factory : 185-25, Mukbang-Ro, Sangdong-Myeon, Gimhae-Si, Gyeongsangnam-Do, Korea (Postal Code : 50805)

www.qlight.com

EN - QLV - 2405A