

## Multiple Function LED Signal Lights

# MFL Series

Operating steady/flashing, strobe, simulated revolving flashing, Multiple function LED signal lights



MFL60

### PRODUCT SPECIFICATION

MFL60 | MFL80  
MFL100 | MFL125

**Materials** Lens-PC, Housing-ABS

**Ambient operating temperature** -30°C to +50°C

**Volume** Max.80dB at 1m

**Protection rating** IP65

**Simulated revolving type(LR) flashing rates** 120-140RPM

**Flashing type(LF) flashing rates** 60-80/min

**Strobe type(LS) flashing rates** 70-80/min

**Compliant with RoHS directive**

- Product has multi functions of LED Steady/Flashing, strobe, and simulated revolving
- Operating options with switches inside product or external connect
- Shock and vibration-resistant, maintenance reduced with long-lasting energy-efficient LED light bulb
- Can select between standard and built-in buzzer type depending on installation environment
- M12 connector type is optionally available(Female M12 connector is not provided)

#### Manual switch to select operation

ON=1/OFF=0 Operate 4 kinds of function by dip switches

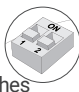

No.	1	2	Operation
0	0	0	LED Steady
1	0	1	LED flashing
2	1	0	LED Strobe
3	1	1	LED Simulated revolving flashing

#### Operation

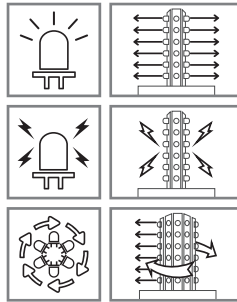

##### • LED Steady/Flashing

Repeat operation of LED signal light on/off

##### • LED Strobe

Short LED Steady/ Flashing cycle. Creates a xenon flashing effect by providing maximum electric current

##### • LED Simulated Revolving

LEDs flash steadily around the cylindrical LED filaments which makes a simulated revolving effect

#### MFL60 Ø60mm Multiple Function LED Signal Lights

Model number	Voltage	Current	Certificates	Weight	Color
MFL60	DC12V-24V	Max.118mA	CE	0.21kg	● R-Red ● A-Amber ● G-Green ● B-Blue
	AC110V-220V	Max.60mA	UL	0.32kg	

※ UL Listed: DC12V-24V

#### MFL80 Ø80mm Multiple Function LED Signal Lights

Model number	Voltage	Current	Certificates	Weight	Color
MFL80	DC12V-24V	Max.118mA	CE	0.28kg	● R-Red ● A-Amber ● G-Green ● B-Blue
	AC110V-220V	Max.75mA	UL	0.51kg	

※ UL Listed: DC12V-24V

#### MFL100 Ø100mm Multiple Function LED Signal Lights

Model number	Voltage	Current	Certificates	Weight	Color
MFL100	DC12V-24V	Max.118mA	CE	0.30kg	● R-Red ● A-Amber ● G-Green ● B-Blue
	AC110V-220V	Max.90mA	UL	0.52kg	

※ UL Listed: DC12V-24V, KC compliant: DC12V, Buzzer type only

#### MFL125 Ø125mm Multiple Function LED Signal Lights

Model number	Voltage	Current	Certificates	Weight	Color
MFL125	DC12V-24V	Max.118mA	CE	0.52kg	● R-Red ● A-Amber ● G-Green ● B-Blue
	AC110V-220V	Max.90mA	UL	0.92kg	

※ DC type model has a free-voltage range of 10V-30V.

※ AC type model has a free-voltage range of 100V-240V.

※ UL Listed: DC12V-24V

#### Wiring Instructions

- External Power line
- UL1015 AWG18(0.75sq) x 2C 400mm
- This product can be wired regardless of polarity.

## Technical Diagram

Units: mm

·MFL60

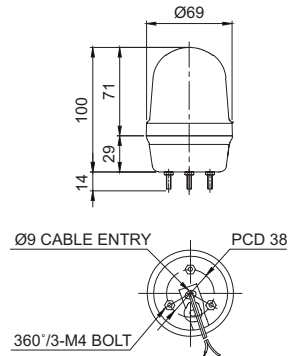

·MFL80

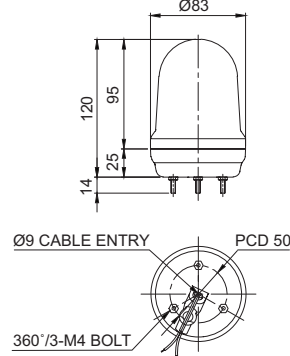

·MFL100

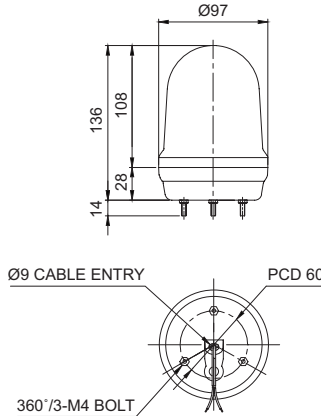

·MFL125

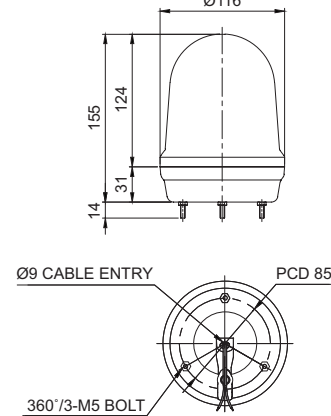

MFL80



MFL100



MFL125

## Customization

- Wall mount bracket options: Bracket structure allows for threading through the bracket hole or into the wall mount

MFL60		MFL80		MFL100 / MFL125	
Wall Mount Bracket TWS45	Wall Mount Bracket TWA45	Wall Mount Bracket TWS80	Wall Mount Bracket TWA80	Wall Mount Bracket SWP125	Wall Mount Bracket SWM125

- Wall-mounted type/Pole-mounted type: For detailed mounting information, please refer to the Q Series in this catalog.

## Wiring Instructions

- External Power line - UL1015 AWG18(0.75sq) x 2C 400mm
- This product can be wired regardless of polarity.

## Ordering Specification

MFL100	-	BZ	-	110/220	-	R
[Model number]		[Buzzer option]		[Voltage]		[Color]
MFL60 MFL80 MFL100 MFL125		(None) - No buzzer BZ - Built-in buzzer		12/24-DC12V-24V 110/220-AC110V-220V		<div>R-Red</div> <div>A-Amber</div> <div>G-Green</div> <div>B-Blue</div>