

Low Intensity LED Aviation Obstruction Light

SAOL1

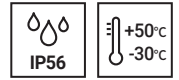

Applied on tall structures for collision avoidance measures and airport runway safety

PRODUCT SPECIFICATION

SAOL1

ICAO standard Low intensity A type
Materials Lens-PC, Housing-PC, Lens ring-STS316L, Pole-STS304, Bracket-Al
Ambient operating temperature -30°C to +50°C
Protection rating IP56
Standard housing color Black
Cable entry Ø20
Light source High intensity light emitting diodes(LED)
Light color Red
Luminous intensity 17cd±25%
Light function Steady

- Low intensity A type aviation obstruction lights are installed onto fixed objects that are less than 150m from the land or water surface
- LED light source with long lifespan (25 times than bulb)decreases the replacement cost of the bulb replacement



SAOL1

SAOL1 Low Intensity LED Aviation Obstruction Light

Model number	Voltage	Power consumption	Certificate	Weight	Light color
SAOL1	DC12V	Max.20W		0.98Kg	● Red
	DC24V				
	AC110V-220V				

※ CE compliant: DC24V

Technical Diagram

Units: mm

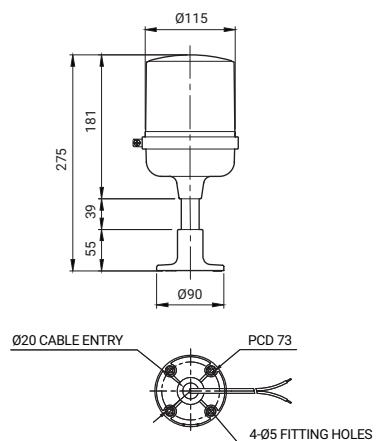

Customization

- Amber housing is available upon request

Ordering Specification

SAOL1	-	24	-	R
[Model number]		[Voltage]		[Color]
SAOL1		12-DC12V 24-DC24V 110/220-AC110V-220V		● Red